

SIGNAGE DETAILS

Site: NatWest Eastbourne Town Centre

Address: 96 Terminus Rd, Eastbourne BN21 3LX

Fascia Panel

1. FASCIA PANEL from 3mm folded aluminium to a depth of 60mm c/w full back tray, all finished Champion Purple (PMS 7678c satin) externally. Face panel located over back tray and secured using M5 dome head screws and rivnuts
2. BUTTON LOGO from 3mm aluminium face c/w 2mm thick 50mm deep machine formed aluminium coil returns, all finished Regal Purple (PMS 2627c satin) externally and Traffic White (RAL 9016 gloss) internally. Face to be fret
cut out logo backed with up 5mm Clear GreenCast acrylic. Backs from 10mm Opal GreenCast acrylic to allow halo illumination, all stood off on 15mm Opal locators. Additional holes for cable entry and drainage required
3. LETTERS from 1.2mm thick 50mm deep machine formed aluminium coil returns, all finished Regal Purple (PMS 2627c satin) externally and Traffic White (RAL 9016 gloss) internally. Faces from 5mm Opal GreenCast acrylic c/w router cut top-hat profile to leave 2mm lip and 3mm shoulder, glued into returns. Backs from 10mm white Foamex with 2mm chamfered front edge, all stood off on 15mm Opal locators. Additional holes for cable entry and drainage required
4. ILLUMINATION via white Oshino Mini Orbis LEDs mounted to internal face of the back panel to face and halo illuminate BUTTON LOGO and face illuminate LETTERS
5. FIXING METHOD to be wall mounted over full aluminium backtray fixed back using WoodTek screws, washers and wall plugs. All fixing heads painted out with touch-up paint supplied



800mm (h) Logo Panel @1:20
OVERALL LOGO: 720x3643mm (X 560mm)

Projecting Sign

1. LIDS 2no. from 3mm aluminium face c/w 2mm thick 50mm deep machine formed aluminium coil returns (back to back), all finished Regal Purple (PMS 2627c satin) externally and Traffic White (RAL 9016 gloss) internally. Face to be fret cut out logo backed up with 5mm Clear GreenCast acrylic
2. BRACKET from 3mm steel base plate arm to a depth of 50mm welded to 3mm formed squircle shaped steel core to a depth of 80mm, all finished Regal Purple (PMS 2627c satin)
3. SHROUD from 2mm aluminium to a depth of 56mm, all finished Champion Purple (PMS 7678c satin) externally. Shroud is sleeved over BRACKET and fixed from the top (to hide fixings) before locating the LIDS
4. ILLUMINATION via white Oshino H358 LEDs mounted around internal face of steel core to face illuminate logo.
5. FIXING METHOD to be wall mounted using M10 anchor bolts or fascia mounted using additional fascia top-hat supports with M10 threaded stud welds, washers and nuts through fascia and BRACKET. Top-hat supports to be secured back using M10 anchor bolts

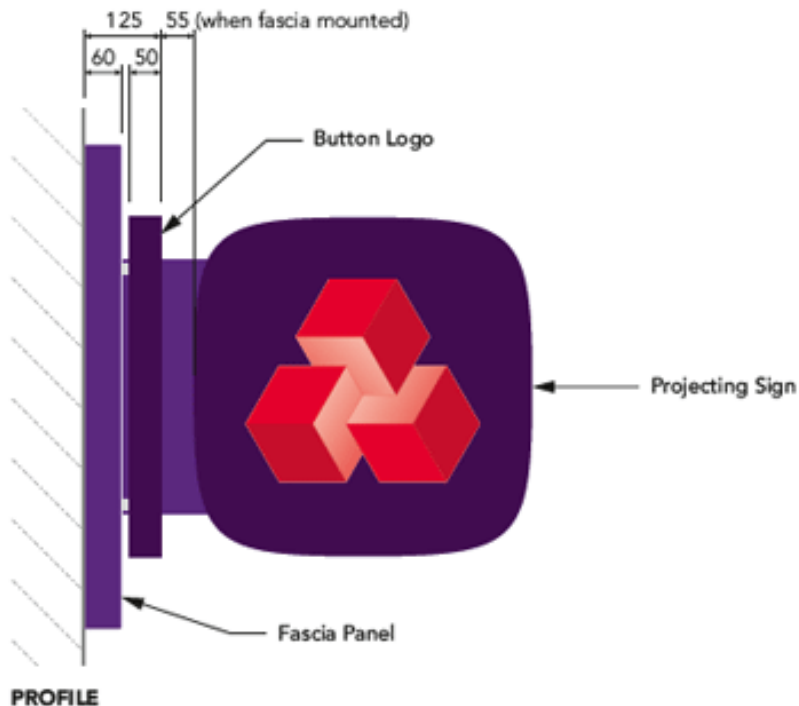

Nameplate

1. FACE UNIT to consist of Clear acrylic panel and insert track:
2. FACE PANEL from 10mm Clear acrylic to have 2.5mm bevelled front edge, all edges to have buff polished finish. Panel c/w printed graphic to rear consisting of reverse printed Purple and Red detail on PVC Clear vinyl backed with matt White vinyl and further backed with matt Black vinyl with aperture stencil cut out to leave clear window for insert
3. INSERT TRACK from router cut 10mm clear acrylic and bonded to the rear of FACE PANEL (and print), using 3M double sided VHB tape 5962F
4. INSERT from 1mm polycarbonate c/w face applied digitally printed detail
5. BACKTRAY from 2mm aluminium to a depth of 20mm c/w keyhole fixings to mount insert track, all finished NW Champion Purple (PMS 7678c satin) externally. Secured using hex bolt through top return to prevent removal of face and security clip to bottom return to secure interchangeable insert
6. FIXING METHOD to be wall mounted using WoodTek screws, washers and wall plugs. FACE UNIT located into BACK TRAY over keyhole fixings and secured through top returns with security hex bolt

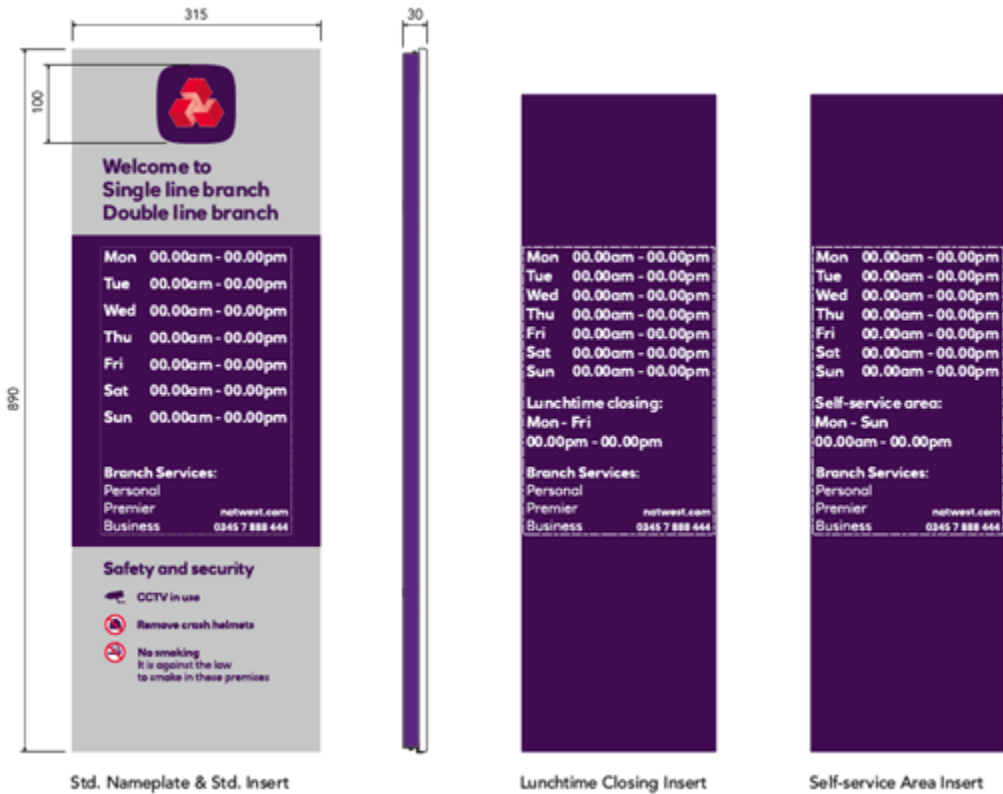

ATM Surround

1. FACE UNIT to consist of 2no. Clear acrylic panels and aluminium lid:
2. PANEL A from 5mm Clear acrylic to have 2.5mm bevelled front edge and router cut out aperture to suit machine type, all edges to have buff polished finish. Panel c/w DTM printed detail to rear, then flooded with d/sided VHB tape except logo area
3. PANEL B from 5mm Clear acrylic to have router cut out aperture to suit machine type, all edges to have buff polished finish. Face of panel c/w csk machine screws set in place with silicone (to avoid damage to PANEL A) prior to being bonded to the rear of PANEL A via VHB tape. Rear of panel flooded with matt Black vinyl to block light except for the Daisy Wheel and Royal Bank of Scotland which illuminate
4. FACE LID from 2.5mm folded aluminium to a depth of 30mm c/w fret cut out aperture to suit machine type and area around logo. Lid to have 25x25x3mm aluminium angle fitted around aperture, all finished Champion Purple (PMS 7678c satin) externally and Traffic White (RAL 9016 gloss) internally (header section)
5. BACK TRAY from 2.5mm folded aluminium to a depth of 30mm c/w fret cut out aperture to suit machine type. All finished Champion Purple (PMS 7678c satin) externally. Tray to have foam gasket applied around aperture for FACE LID angle to but up to
6. VERT. ACCENTS from 2no. lengths of 30x30mm NW accent extrusion c/w Opal acrylic lens and Purple printed vinyl. Accents are positioned to face backwards and out to each side. Accent finished Champion Purple (PMS 7678c satin) externally
7. ILLUMINATION from White Chiplight XO LEDs fitted to the BACK TRAY to face illuminate the logo and letters. Rear facing VERT. ACCENTS illuminated to create halo effect using White LEDs set inside channel
8. FIXING METHOD to be wall or glass mounted using WoodTek screws, washers and wall plugs/glass tape for site specific fixing grounds. FACE UNIT located over BACK TRAY and secured through

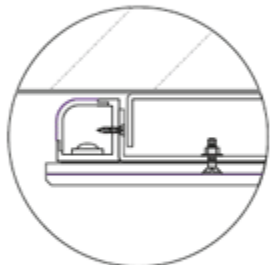
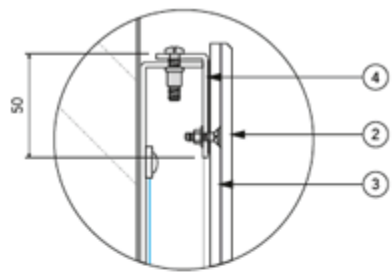
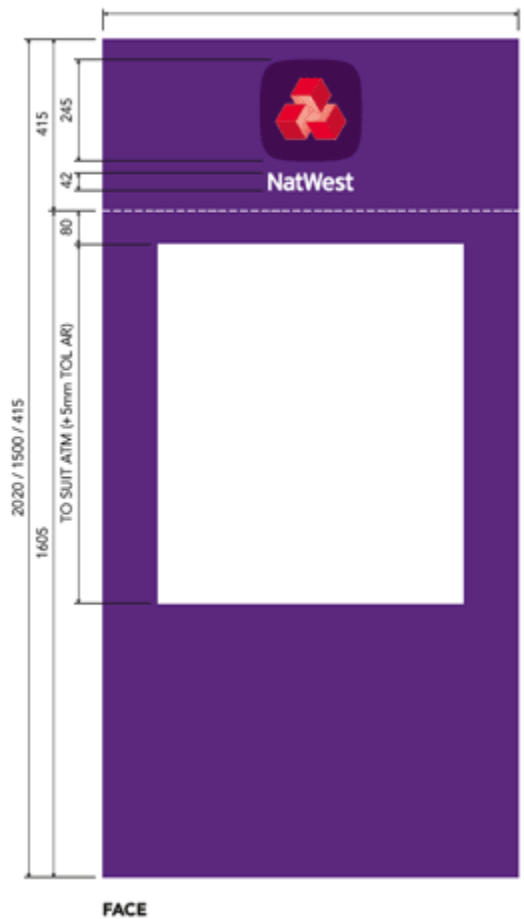

PLAN DETAIL OF ACCENT

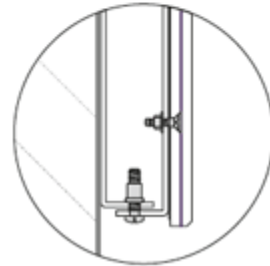

Suspended Signage

- 1. LIDS 2no. from 3mm aluminium face c/w 2mm thick 50mm deep machine formed aluminium coil returns (back to back), all finished Regal Purple (PMS 2627c satin) externally and Traffic White (RAL 9016 gloss) internally. Face to be fret cut out logo backed up with 5mm Clear GreenCast acrylic.
- 2. BRACKET from 3mm formed squircle shaped steel core to a depth of 80mm welded to 2no. Ø30mm steel drops and fixing plate, all finished Silver (RAL 9006 satin).
- 3. ILLUMINATION via white Oshino H358 LEDs mounted around internal face of steel core to face illuminate logo.
- 4. FIXING METHOD to be suspended using M10 anchor bolts through fixing plate. Fixing plate and drop detail subject to site requirements

